

FOR LEASE

4,024 SF | Corona, CA | Office Suite in a High-Image, Two-Story Office Building

Presented by Strata Realty, Inc. | www.stratarealty.com | T (951) 280-1733 | F (951) 280-1739

**4,024 SF OFFICE SUITE IN HIGH-IMAGE BUILDING**
MEDICAL USES ALLOWED**Location**1181 California Avenue, Suite 203
Corona, CA 92881**Features**

- Concrete tilt-up office building
- Three (3) private offices
- One (1) conference room
- Training room
- Kitchen area
- Abundant window lines throughout
- Freeway fronting signage available
- High-efficiency building - low load factor allows for more usable area, and solar panels installed on property to lower energy costs
- Desirable south Corona location
- Within walking distance to many retail amenities nearby
- Great access to 91 and I-15 freeways

**Contact:****Timothy Hawke, SIOR**

(951) 280-1733 | thawke@stratarealty.com

Adam Silverman

(951) 280-1733 | asilverman@stratarealty.com

Jason Palda

(951) 280-1733 | jpalda@stratarealty.com

DRE InformationTimothy Hawke's license number is 01403432
Adam Silverman's license number is 01397929
Jason Palda's license number is 01820370

FOR LEASE

4,024 SF | Corona, CA | Office Suite in a High-Image, Two-Story Office Building

Contact: Tim Hawke, Adam Silverman, or Jason Palda | T (951) 280-1733

FLOOR PLAN

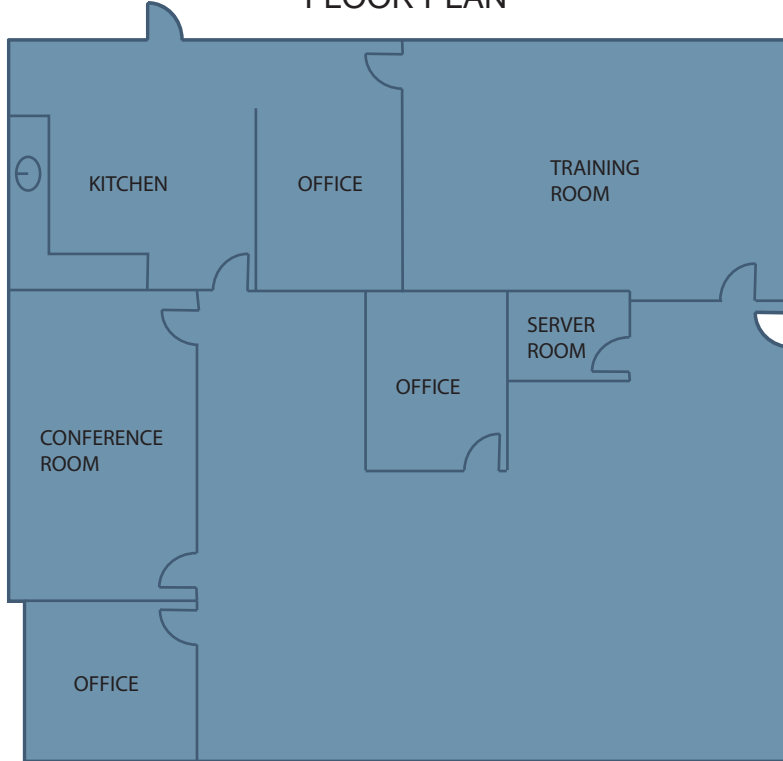

DRE Information